

MODEL "1/2" and "1-1/2"

MODEL "O"

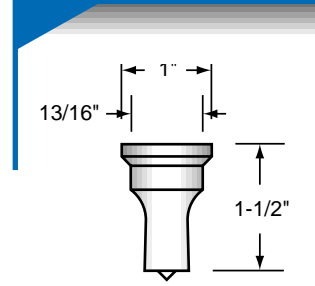

3620

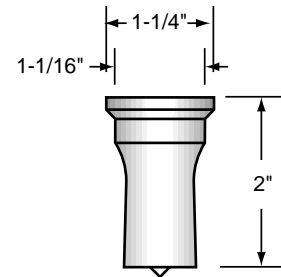

6640

MODEL "1/2"

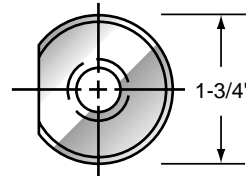

8530

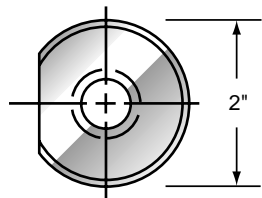

1400

MODEL "1-1/2"

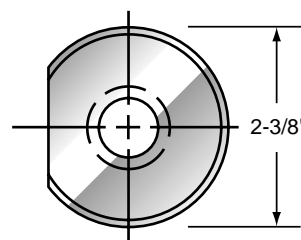

6650

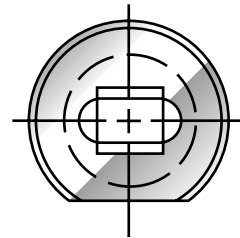
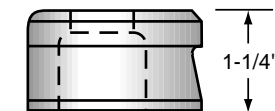
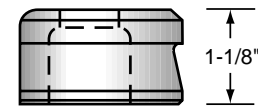

Standard hole position
in relation to flat

MODEL "2-1/2"

Before 1952

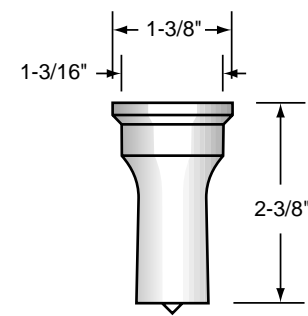

9030

After 1952

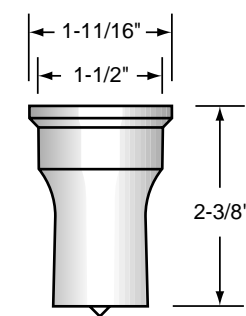

3T10

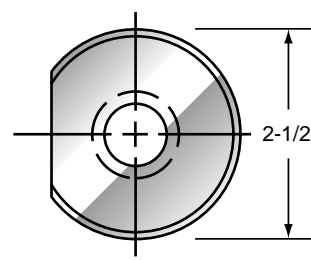

9040

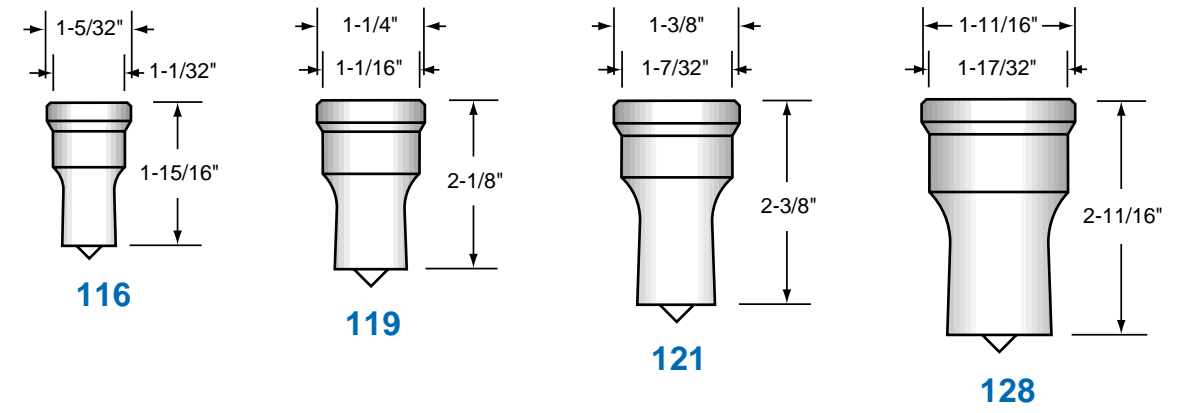
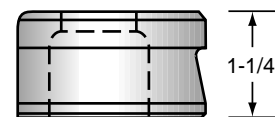

116

119

121

128

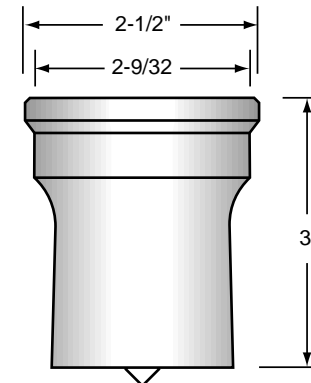

137

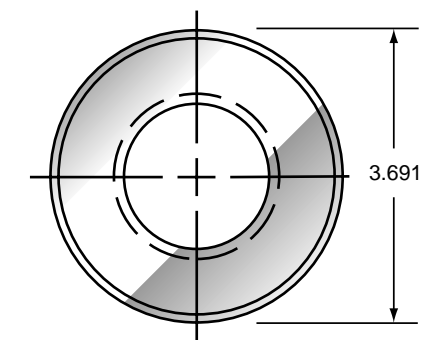

6234

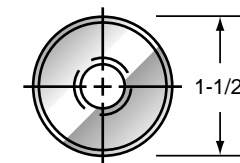
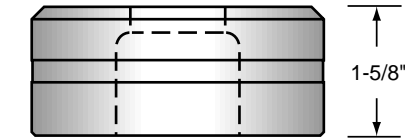

308

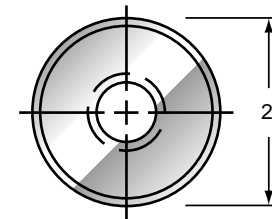
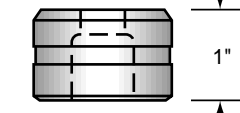

317

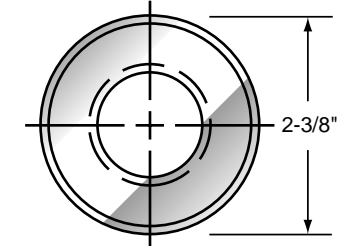
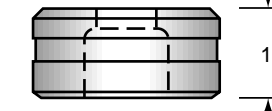

319

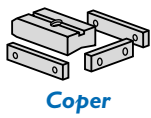
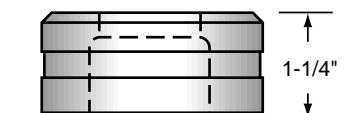

Coper

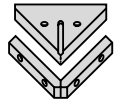

Notcher



Bar Cutter

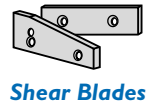

Shear Blades

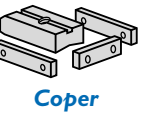

Coper

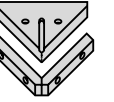

Notcher

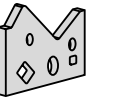

Bar Cutter

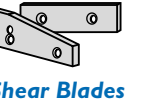

Shear Blades