

NITTO KOHKI

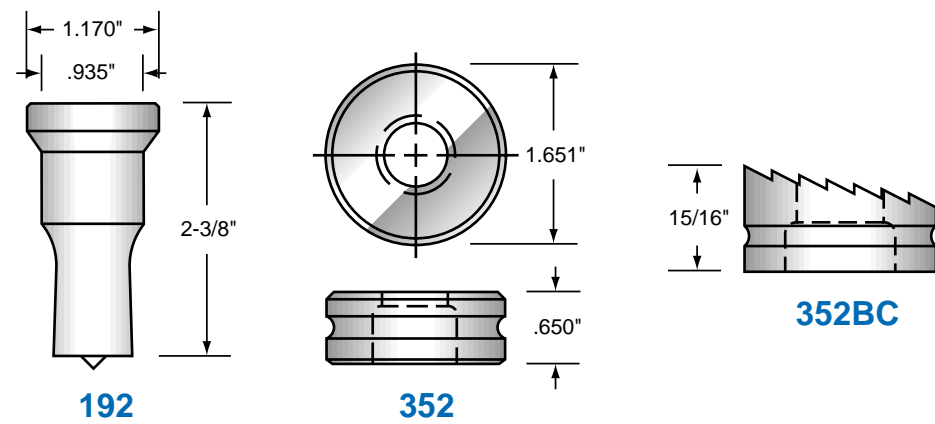

SIZES

- 5/16
- 7/16
- 9/16
- 11/16
- 13/16
- 15/16

ENERPAC

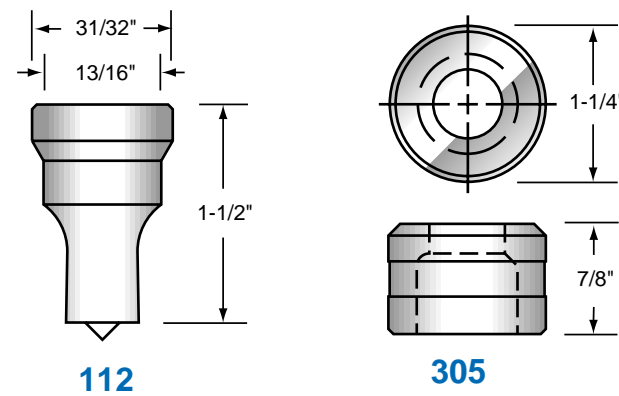

SIZES

- 5/16
- 7/16
- 9/16
- 11/16
- 13/16

HUSKIE, POWER TEAM, PORT-A-PUNCH

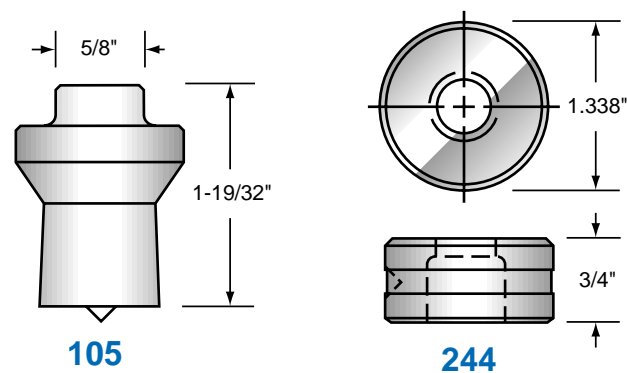

SIZES

- 5/16
- 7/16
- 9/16
- 11/16
- 13/16

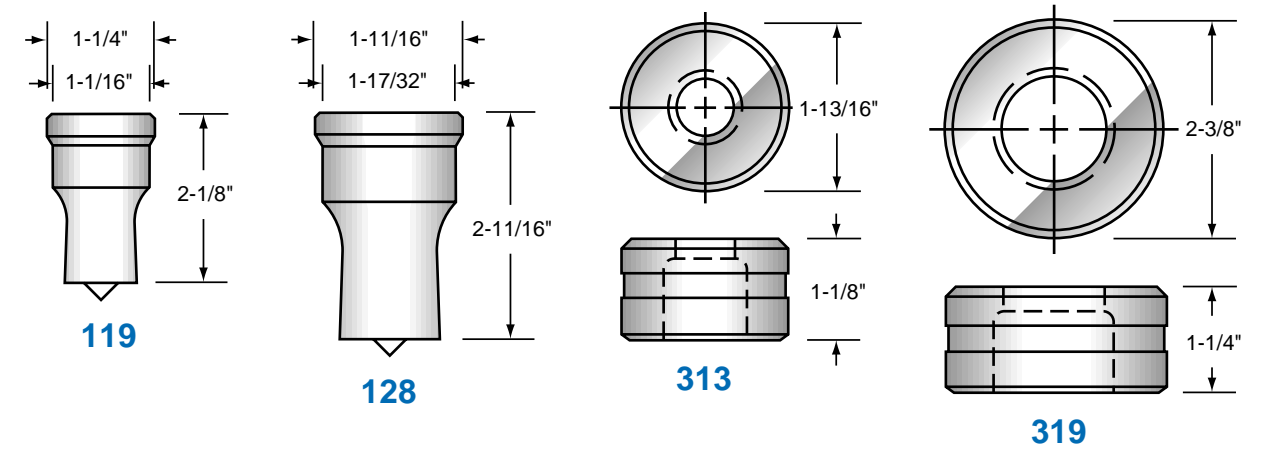

American Punch recommends a keyway on all punches other than round.

Standard keyway uses a round key

Standard location

2 set screw spots provided on all dies other than round.

SHEAR BLADES

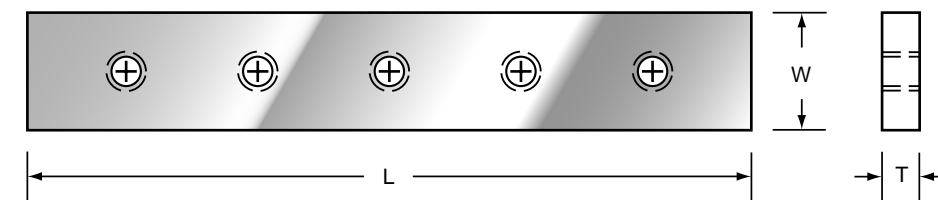

Part No.	"L"	"W"	"T"	No. of tapped holes
3153	16-5/8"	2"	1"	5
4327	14-5/8"	1-12"	3/4"	5
6273	11-1/4"	1-12"	3/4"	4
4328	20-1/2"	2"	1"	6

PUNCH STEM

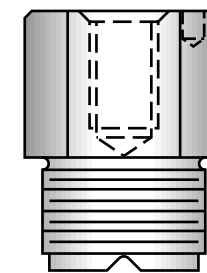

COUPLING NUT

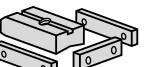
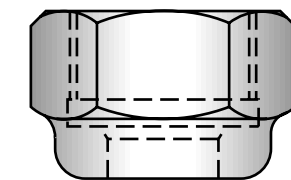

Coper

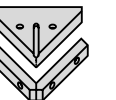

Notcher

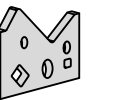

Bar Cutter

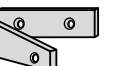

Shear Blades